330

South Tryon



PROPERTY HIGHLIGHTS

- / Next to Latta Arcade and Romare Bearden Park
- / 2 Blocks from Light Rail Stop on 3rd Street
- / 3.0 per 1,000 Parking
- / Full 3rd Floor Available
- / On-Site Restaurant, Famous Toastery

**FLEXIBLE
TERM OPTION**

**3rd Floor
up to 11,200 RSF**



Full 3rd Floor up to 11,200 RSF

Available with
Furniture: 7,231 RSF

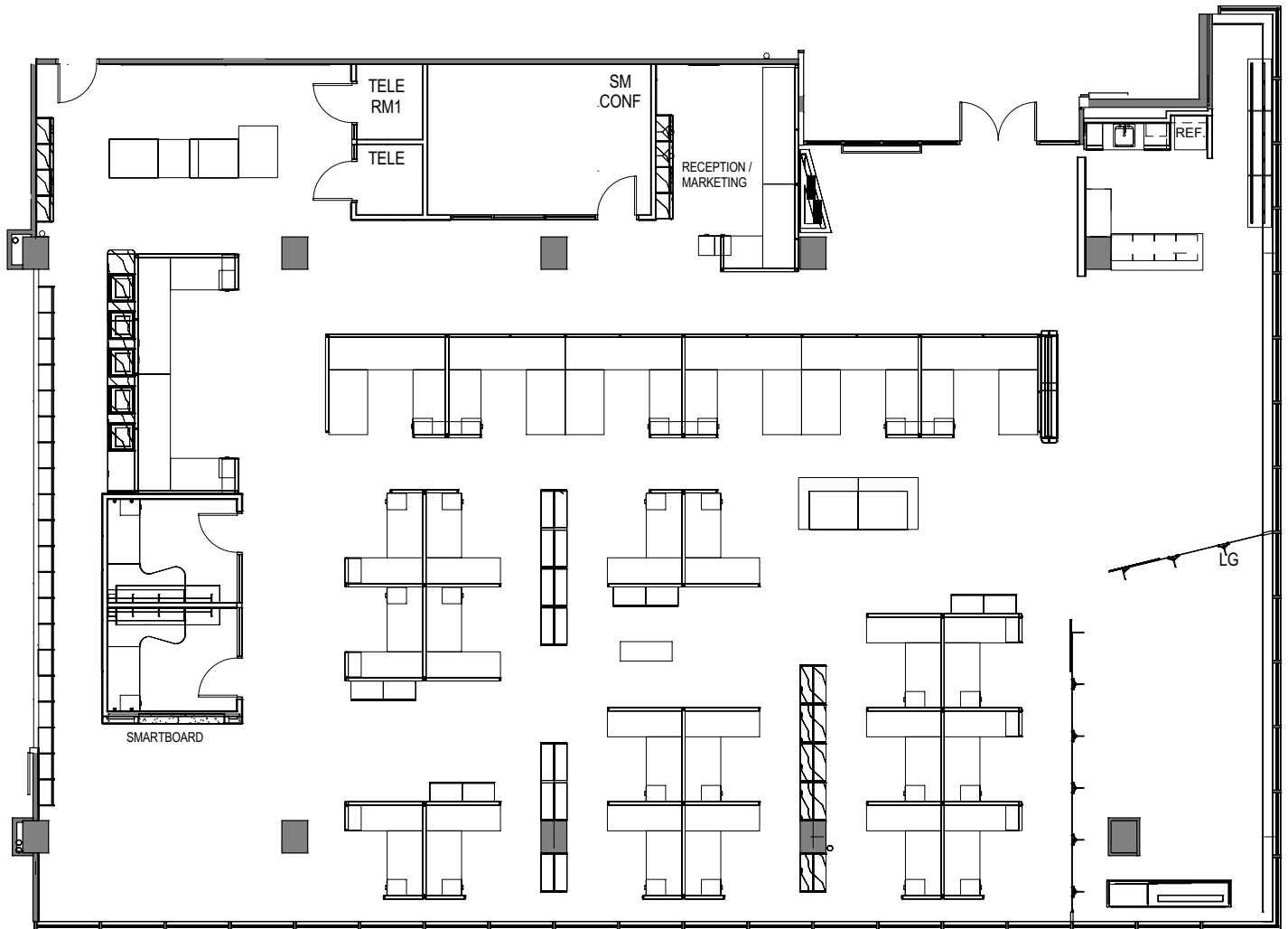

Ted Lee
tedlee@spectrumcos.com

Dillard Williams
dwilliams@spectrumcos.com

704 358 1000

Suite 300
9,093 RSF



Modern build-out, panoramic views, all glass conference room, break room, & concrete flooring.



CENTRAL Tryon Street Location

