

330

SOUTH TRYON



PROPERTY HIGHLIGHTS

- / Flexible term
- / Next to Latta Arcade and Romare Bearden Park
- / 2 Blocks from Light Rail Stop on 3rd Street
- / 3.0 per 1,000 Parking with direct 3rd floor access

MOVE-IN READY

**Full 3rd Floor
with flexible SF**

Full 3rd Floor up to 11,250 RSF

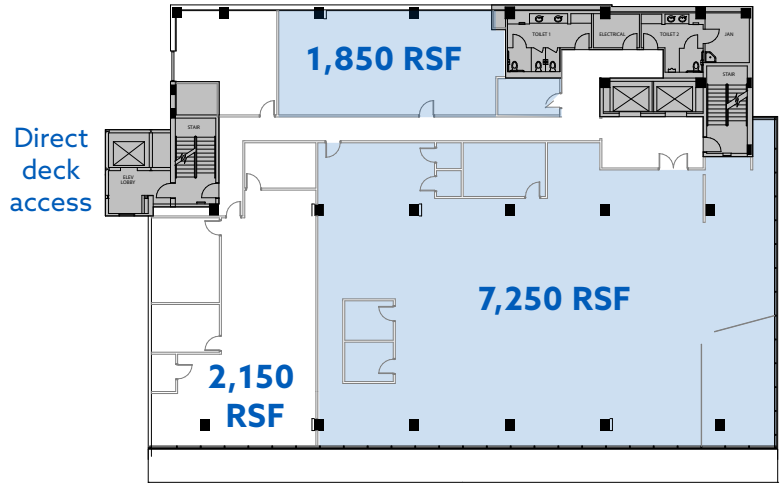

Suite 300 with furniture: 7,250 RSF

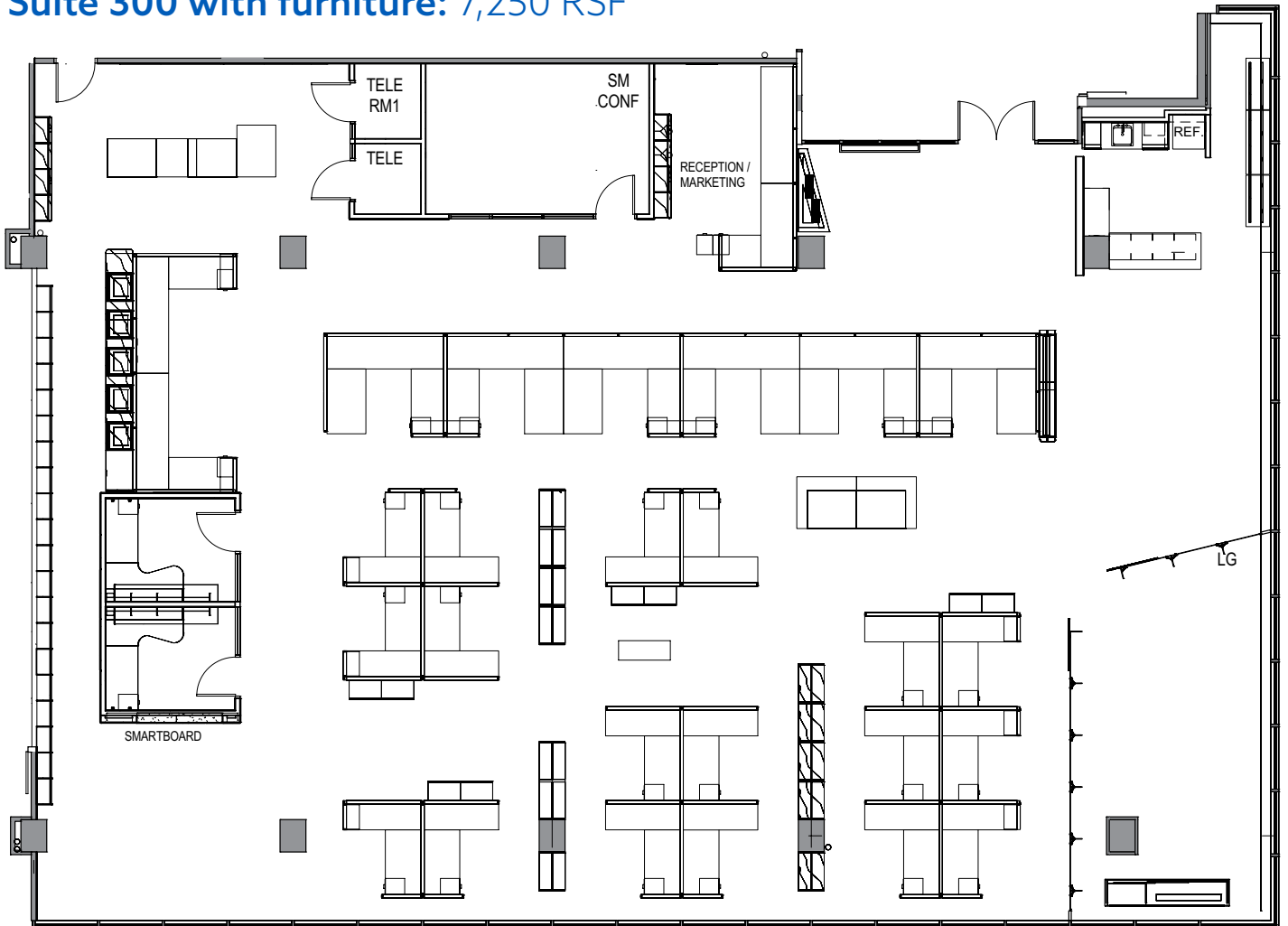



Modern build-out, panoramic views, all glass conference room, break room, & concrete flooring.



Central South Tryon Location

Beside Latta Arcade's 10+ dining and retail options

Surrounded by dining, parks, and top tier hotels

2 blocks from the light rail

